

# AE Series - Hydraulic Automobile Elevator

- » Rider permitted and designed to carry cars, SUVs and trucks between multiple levels
- » Allows for greater flexibility in building design and enhances property value
- » Ideal for use in parking garages, condominiums, car dealerships and homes in busy urban environments
- » Environmentally friendly, non-buried, hydraulic cylinder drive system
- » Exceeds elevator safety code standards CSA B44 & ASME A17.1

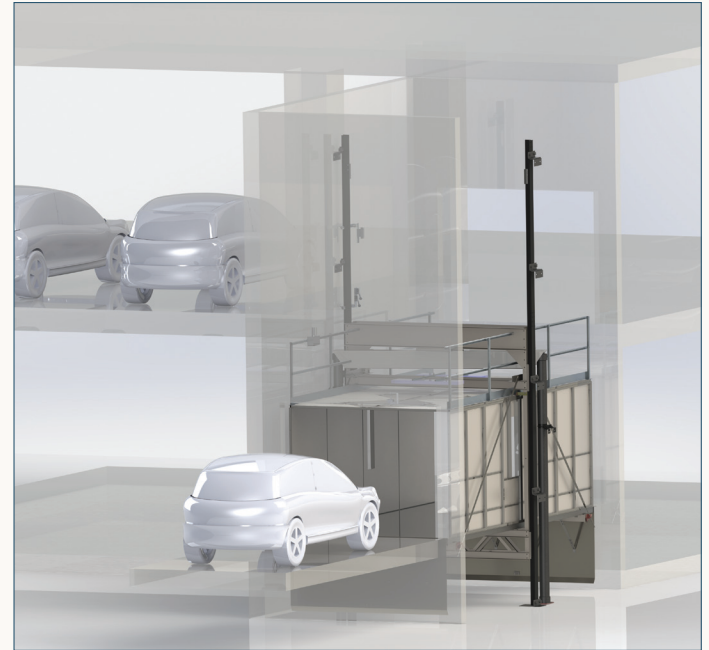

# Specifications:

## Design Guarantee

- » Painted steel checkered floor plate to provide a non-skid surface.
- » Ceiling is expanded mesh panels, with rooftop controls.
- » Superior ride quality that is smooth and vibration-free with minimal noise concerns.
- » Will pass all stipulated deflection tests.
- » Emergency alarm bell, emergency lighting and an inter-communication device.

## Pumping Unit and Controls

- » Submersible gear pump, completely enclosed, fan cooled motor.
- » Manual shut off valve and manual lowering valve.
- » 2-Speed valve controls to provide soft starts and stops.
- » 2-way leveling feature which allows the elevator to re-adjust for leveling accuracy.
- » Power requirements are 208V/230V/460V/575V, 3-phase 60Hz.
- » Single automatic momentary contact push buttons.
- » Emergency stop button is included.
- » Optional keyed switch to secure against unauthorized use of the controls.

## Doors

- » Heavy duty vertical bi-parting doors (standard 84" high) with 1.5hr fire rating.
- » Single/two section vertical slide up car gate(s).

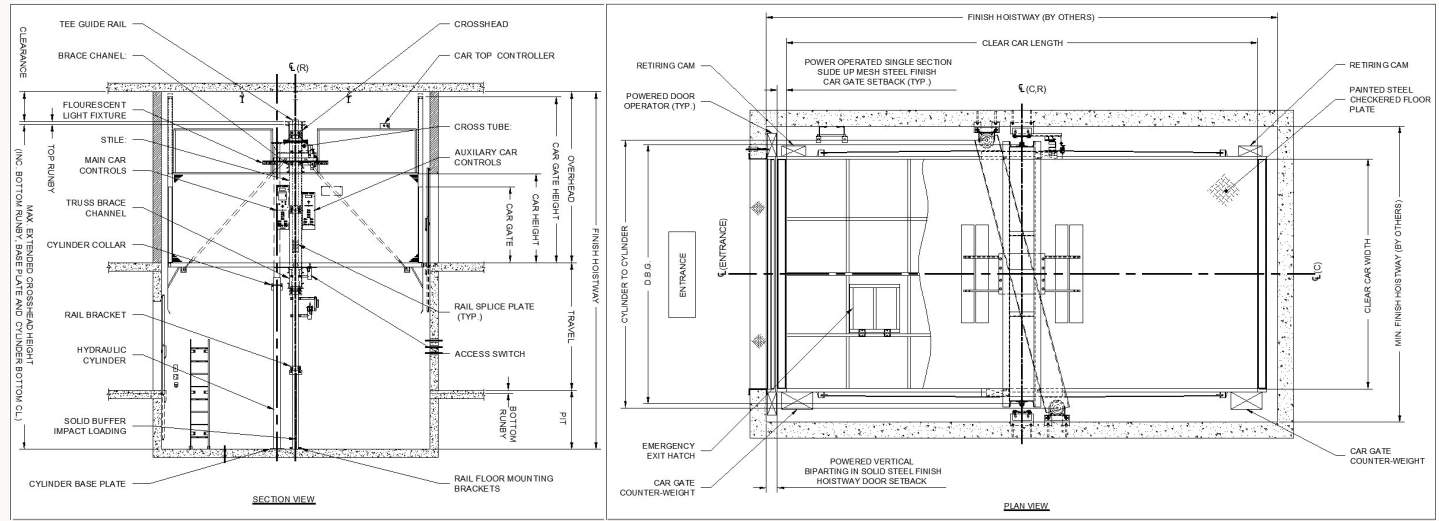

INLINE ENTRANCES DESIGN SHOWN HERE

- » Electrical-mechanical interlocking so that elevator will not operate if door is open.
- » In-line or through cab entrances available.

## Optional Features

- » Battery operated emergency power for lowering.
- » Submersible motor to reduce noise.
- » Manual swing doors (requires continuous pressure button controls).
- » Increase in entrance height for oversize loads.
- » Various cab finishes.
- » Various solutions for ambient conditions (low temperatures, moisture, etc.)
- » Class C Loading.
- » Oil cooler (for high use applications).
- » Wooden bumpers on non access walls.
- » Remote access key FOBs for ease of access.

